

## M1C

### Professional Passthrough Dishwasher with Heat Condensing Unit – 450mm Rack W 630mm x D 650mm x H 2025mm

The Washtech Professional Range combines the best of modern technology with an uncompromising use of high quality components and heavy duty stainless steel construction – machines you can rely on for great wash results for many years to come.

The Washtech M1C incorporates intuitive electronic controls providing soft wash start, eco power save system, easy to read temperatures for HACCP reporting, chemical pump adjustments and priming, cycle customisation, immediate fault diagnosis and many other options. Where space in a restaurant, café or aged care facility is at a premium, the M1C is a great solution. With the use of 450mm racks the M1C requires a bench gap just of 510mm, has a depth of only 650mm and is compatible with 600mm deep benching.

Equipped with a heat condensing unit the M1C runs on a cold water supply, which allows for easier and lower cost water treatment options. The use of the steam to pre-heat the cold inlet water enables the M1C to reduce energy consumption, emissions and ventilation requirements, while also providing a cooler and drier operating environment.

#### Standard Features

- Autostart on door closure 1, 2 and 3 minute cycles (optional 2, 4, 6 minute cycles)
- Washes up to 960 plates per hour
- Easy installation supplied complete with:
  - Water supply hose
  - Dual detergent and rinse aid pumps with injector lines
  - Drain pump outlet hose
  - Compact bench gap (510mm)
  - No commissioning required
- Reliable results through robust stainless steel wash and rinse arms with precision stainless jets
- Durable stainless steel construction
- Moffat's Comprehensive 5-2-1 Warranty
- Heat Recovery Condensor preheats cold water supply and significantly reduces steam emitted
- Suitable for installation without canopy in many situations – with good general dishroom ventilation
- Self cleaning jets located above the heat condenser flush the unit every time the machine is drained
- Low cold water consumption of 2.4 litres per cycle
- Assured final rinse ensures the correct temperature and pressures every time through it's rinse pump and 316 stainless break tank
- Double filtration system via scrap trays and separate wash inlet filter
- Soft start ensures great wash results through progressively pressurising the cycle to provide a consistent and even clean every time
- EcoPower reduces temperatures and energy consumption when machine is not being used

#### Includes:

- 2 x 600 70080 - 450mm cup rack
- 1 x 600 70081 - 450mm dish rack
- 1 x C660503 - cutlery container



## M1C

Professional Passthrough Dishwasher with Heat Condensing Unit – 450mm Rack  
**W 630mm x D 650mm x H 2025mm**

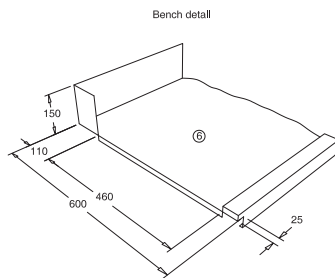
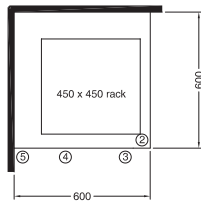
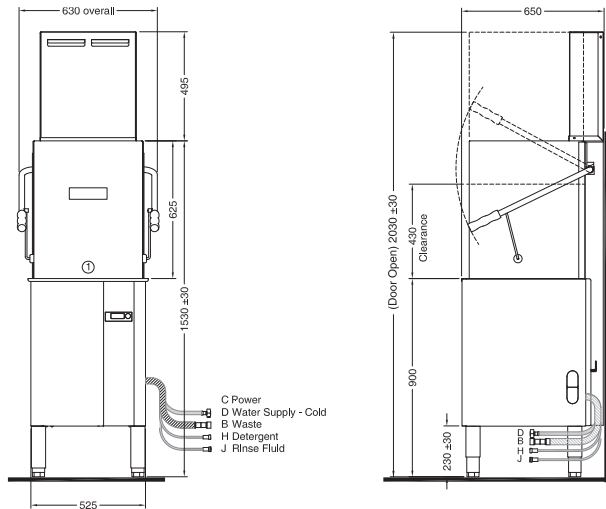

- In-line Installation**  
 ① Bench gap 510  
**Corner Installation**  
 ② wall to front inside corner of wash tank 600  
 ③ machine must face left for access to controls  
 ④ allow 300 clearance beneath bench to front for service access  
 ⑤ splashback return no higher than 150  
 ⑥ left side is mirror image

### A Cold Water

Temperature	20°C
Connection	3/4" male hose supplied
Pressure	200-350kPa
Flow	20 litres per min
Quality	Potable & soft
Backflow Prevention	Atmospheric Vacuum
Consumption	2.4 litres per cycle

### B Waste

Connection	Hose supplied for 38mm open standpipe 750 high to sink trap
------------	---

### C Electrical

Single phase	240V 50Hz 15 amp; OR,
Single phase	240V 50Hz 25 amp; OR,
Three phase	400V 50Hz 15 amp per phase

#### Nominal Power Consumption

1P / 15A\* = 2.5kW rinse / 2.5kW wash / 2.9kW max; OR  
 1P / 25A\* = 5.0kW rinse / 2.5kW wash / 5.4kW max; OR  
 3P / 15A = 7.5kW rinse / 2.5kW wash / 8.6kW max

### Dimensions

Width	630mm
Depth	650mm
Height	2025mm
Weight	80kg

### Packed Dimensions

Width	695mm
Depth	750mm
Height	1970mm
Weight	101kg
Cubicmetres	1.03m <sup>3</sup>

### Water Quality Requirements

Hardness	ppm	pH
Min	20	7
Max	100	8
Ions	Cl <sup>-</sup> SO <sub>4</sub> Fe Mn Cu CL <sub>2</sub>	
Max mg/l	100 400 0.1 0.5 0.05 0.1	

Refer operator manual for installation instructions  
 \*Power modifications are factory order options only



moffat.com.au

Australia  
 Moffat Pty Limited

Victoria/Tasmania  
 740 Springvale Road  
 Mulgrave, Victoria 3170  
 Telephone 03-9518 3888  
 Facsimile 03-9518 3833  
 vsales@moffat.com.au  
 www.moffat.com.au

New South Wales  
 Telephone 02-8833 4111  
 nswsales@moffat.com.au

South Australia  
 Telephone 03-9518 3888  
 vsales@moffat.com.au

Queensland  
 Telephone 07-3630 8600  
 qldsales@moffat.com.au

Western Australia  
 Telephone 08-9202 6820  
 bgarcia@moffat.com.au

### ISO9001

All Washtech products are designed and manufactured by Washtech using the internationally recognised ISO9001 quality management system, covering design, manufacture and final inspection, ensuring consistent high quality at all times.

In line with policy to continually develop and improve its products, Washtech reserves the right to change specifications and design without notice.



© Copyright Moffat Ltd  
 Moffat / 11.16

an Ali Group Company



The Spirit of Excellence