



## STW660 Series Water Cooler

This West Australian made water cooler was designed to produce a serious amount of cold water and is nearly always found in the north west providing cold water to the workers on mine sites. It is designed to provide 660 litres of 10°C water per hour in rated conditions<sup>1</sup>.

Fully insulated storage tank with interwoven refrigeration encourages quick and efficient cool down.

Modern styling and robust construction with 304 grade stainless steel panels to all sides.

520 litres of storage with 140 litres per hour recovery

Advanced Arcus digital controller offers greater control, increased efficiency and easy fault diagnosis.

Three high flow taps to allow multiple users at one time

Adjustable drip tray

Removable side panel for easy service.

Unlike some, it's not just our tapware that carries watermark approval, our entire unit is **FULLY WATERMARK APPROVED**

Optional pressure pump allows you to feed pre-chilled water to external devices such as ice machines, dummy water cooler tops (eg WM18B) and other devices requiring cold water



## TECHNICAL DATA

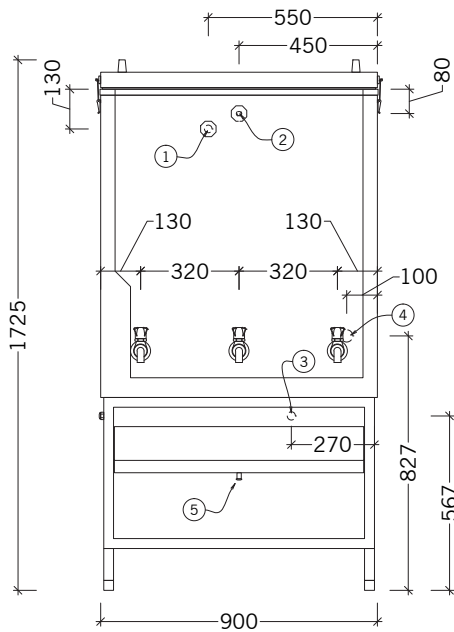

### Connections

1. Overflow socket with strainer (3/4" BSP, Female)
2. Water Inlet (3/4" BSP, Female)
3. Tank Drain (1/2" BSP, Male) (rear of unit)
4. Gravity fed remote appliance connection (1/2" BSP, Female) (rear of unit)
5. Drip tray with drain socket
6. Main pressure remote appliance connection (1/2" BSP, Female) -PP Models Only
7. Digital Controller

### Power

240V +-10%, 50hz, 11.5amps

### Packaged Dimensions (no skid)

950 x 990 x 1825mm (WxDxH)

### Unit Weight (Empty, No Packaging)

214kg

## AIR FLOW

The STW660 is often used in a location where it is advisable to duct the hot air created by the refrigeration process out of the room. When this is the case we manufacture and supply duct work that is mounted to the rear of the unit through which the hot air passes out through the wall of the building.

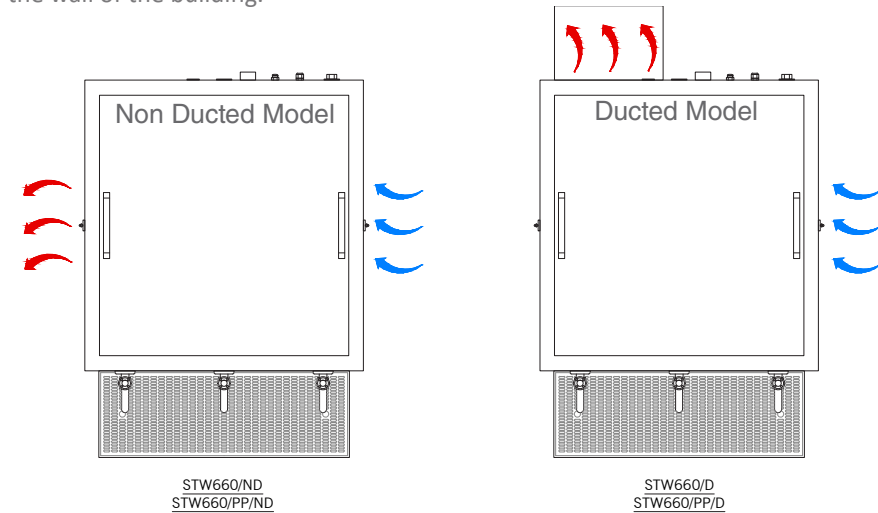

## OPTIONS

- Triple action 5 micron water filter.
- External UV sterilisation system.
- Condenser Coil Protection to reduce coil corrosion in harsh environments.
- In built pressure pump
- External duct work to exhaust hot air from the room it is located in.

HAVE YOU SEEN OUR FULL RANGE AT [WWW.ARCUS.COM.AU](http://WWW.ARCUS.COM.AU)?



1 - Approximate litres per hour is based on the tank size plus the units hourly recovery rate at its rated conditions. For example the STW 78 has a 47 litre tank and 31 litres recovery this gives 78 litres per hour.

2 - Please specify when requesting a price, tap combinations should be set prior to dispatch from our factory.

In line with policy to continually improve its products, Arcus Australia Pty Ltd reserves the right to change specifications and design without notice. E&OE

